

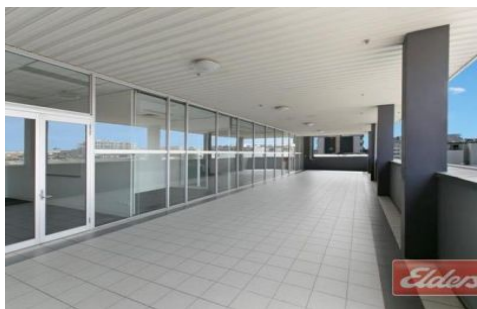

# Commercial



## 76 Commercial Road NEWSTEAD QLD

76 Commercial road is easily one of Newstead's premier character office buildings, located between James Street and Gasworks. Other features of the property include:

- 36 - 194m<sup>2</sup> of character office
- Onsite assigned and visitor parking
- Will suit all users
- Creative features with polished concrete and exposed ceilings in common areas
- Exposure & signage opportunities to Commercial Road
- Onsite showers and lockers for staff
- Lift Access to all floors
- Competitive rental prices on offer!

For more information or to arrange an inspection, please

[For full version visit the website](https://www.elderscommercialbrisbane.net.au/3223765)

**Type** : Offices

**View** : <https://www.elderscommercialbrisbane.net.au/3223765>



**Clinton Mallan**  
**(07) 3252 4999**