

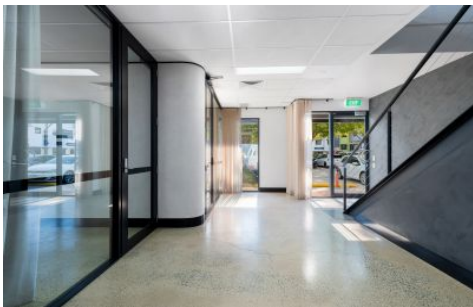

Commercial



28/76 Doggett Street NEWSTEAD QLD

3

Elders Commercial Brisbane are pleased to present this corner position space conveniently located Newstead Commercial Village and offering 194m2 over 2 levels. The property features reception area, 4 private offices and amenities on the ground floor and a large open plan area with amenities on the 1st floor.

Key features of the property include:

- 194m2 flexible office space - availability for dual tenancies
- Three (3) car parks + visitor parking
- Newstead Commercial Village office park environment
- Full data cabling and alarm system

Located in the heart of Newstead this well connected

[For full version visit the website](https://www.elderscommercialbrisbane.net.au)

Type : Offices
Building Size : 194 sqm
View : <https://www.elderscommercialbrisbane.net.au/8386529>



Clinton Mallan
(07) 3252 4999



Will Kennedy
(07) 3252 4999